

## 15453

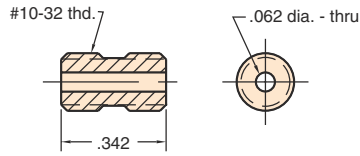

Male 10-32 Coupling



**Material:** Stainless steel

**Thread:** 10-32

**Seals:** Loctite necessary

**Use:** Excellent for a surface to surface connection of female 10-32 products

## 15010



10-32 Extension Fitting

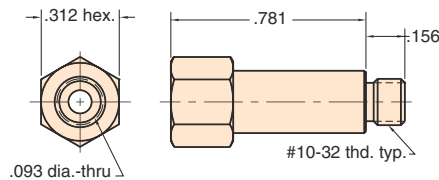

**Material:** Brass

**Thread:** 10-32

**Gasket:** Buna-N gasket furnished in package only. Not included when ordered in bulk.

**Use:** To provide extension for convenience in assembling components

**Options:** (-NP)



## 15004



10-32 Female Hex Coupling

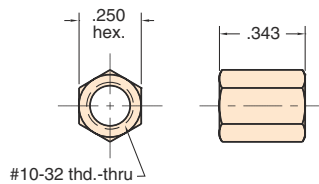

**Material:** Brass

**Thread:** 10-32 tapped

**Use:** For coupling two 10-32 male fittings

**Options:** (-NP)



## 11999



10-32 Male Connector

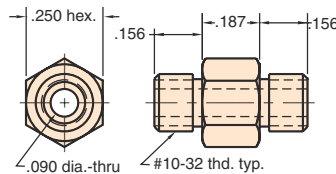

**Material:** Brass

**Thread:** 10-32 both ends

**Gasket:** (2) Buna-N gaskets furnished in package only. Not included when ordered in bulk.

**Use:** For coupling cylinders directly to valves, and many other coupling arrangements

**Options:** (-NP)



## 3810-1



1/8 NPT to 1/8" OD Tube Compression Fitting

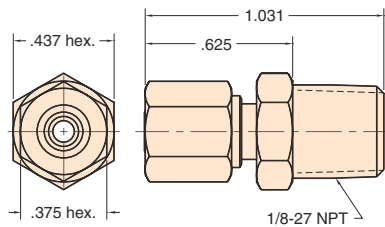

**Material:** Brass

**Thread:** 1/8 NPT

**Use:** Joins standard size pipe to 3811-1 copper or 3814-2 nylon tubing

**Replacement Ferrule & Nut:** 15155

**Options:** (-NP)

**Features:** One piece ferrule and nut for fast, easy insertion of tube



## 3810-2



1/16 NPT to 1/8" OD Tube Compression Fitting

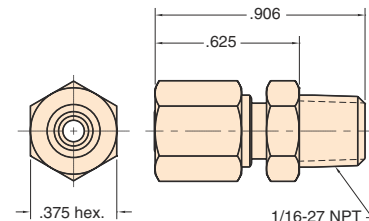

**Material:** Brass

**Thread:** 1/16 NPT

**Use:** Joins standard size pipe to 3811-1 copper or 3814-2 nylon tubing

**Replacement Ferrule & Nut:** #15155

**Options:** (-NP)

**Features:** One piece ferrule and nut for fast, easy insertion of tube



## SWIVEL FITTINGS

Minimatic® swivel connector fittings are very efficient in applications where joints need to be disconnected and reconnected frequently. Made with a threaded connection on one end and a swivel connection on the other, these fittings provide a true cost savings on pneumatic circuit designs. They are valuable also where short lengths of hose are being connected.

Note: These are not rotating joints. They are assembly benefits... not to be used as a constant rotation junction.

### 15040



10-32 Swivel Fitting

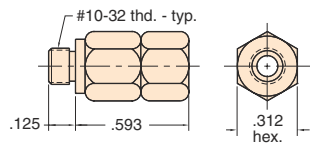

**Material:** Brass

**Thread:** 10-32

**Gasket:** Buna-N gasket furnished in package only. Not included when ordered in bulk.

**Use:** Allows connection to rotate for tightening in confined spaces

**Note:** Used for positioning not for rotary connector

**Options:** (-NP)



### 15045



10-32 to 1/8" ID Hose Swivel Fitting

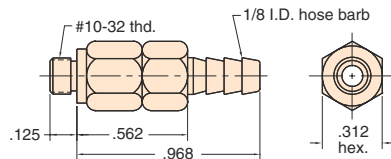

**Material:** Brass

**Thread:** 10-32

**Gasket:** Buna-N gasket furnished in package only. Not included when ordered in bulk.

**Use:** Allows connection to rotate for tightening in confined spaces

**Hose Barb:** 1/8" ID hose

**Note:** Used for positioning not for rotary connector

**Options:** (-NP)



### 15050



1/8 NPT to 10-32 Swivel Adaptor

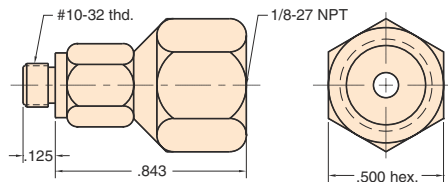

**Material:** Brass

**Thread:** 10-32 and tapped for 1/8-27 NPT

**Gasket:** Buna-N gasket furnished in package only. Not included when ordered in bulk.

**Use:** Allow connection to rotate for tightening in confined spaces

**Note:** Used for positioning not for rotary connector

**Options:** (-NP)



### 15055



1/8 NPT to 1/8" ID Hose Swivel Fitting

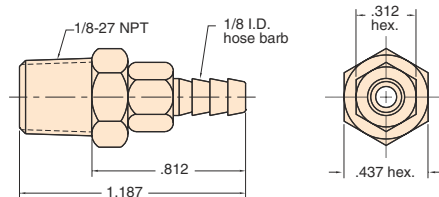

**Material:** Brass

**Thread:** 1/8-27 NPT

**Seals:** Buna-N o-ring

**Use:** Allows connection to rotate for tightening in confined spaces

**Hose Barb:** 1/8" ID hose

**Note:** Used for positioning not for rotary connector

**Options:** (-NP)



### 15060



1/8 NPT to 10-32 Swivel Adapter

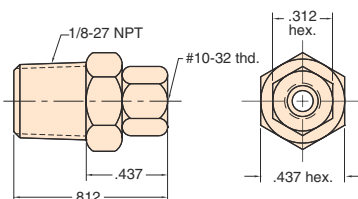

**Material:** Brass

**Thread:** 1/8-27 NPT male and 10-32 tapped

**Seals:** Buna-N o-ring

**Use:** Allows connection to rotate for tightening in confined spaces.

**Note:** Used for positioning not for rotary connector

**Options:** (-NP)



## Clippard Slip-on Fitting Assembly

This semi-automatic rotary solder machine was designed and built in-house for the Clippard slip-on fitting product line. Incorporated into the design are Clippard modular valves, stainless steel cylinders, brass valves, flow controls, slip-on fittings, hose and super structure providing framework, control, indexing and parts handling.

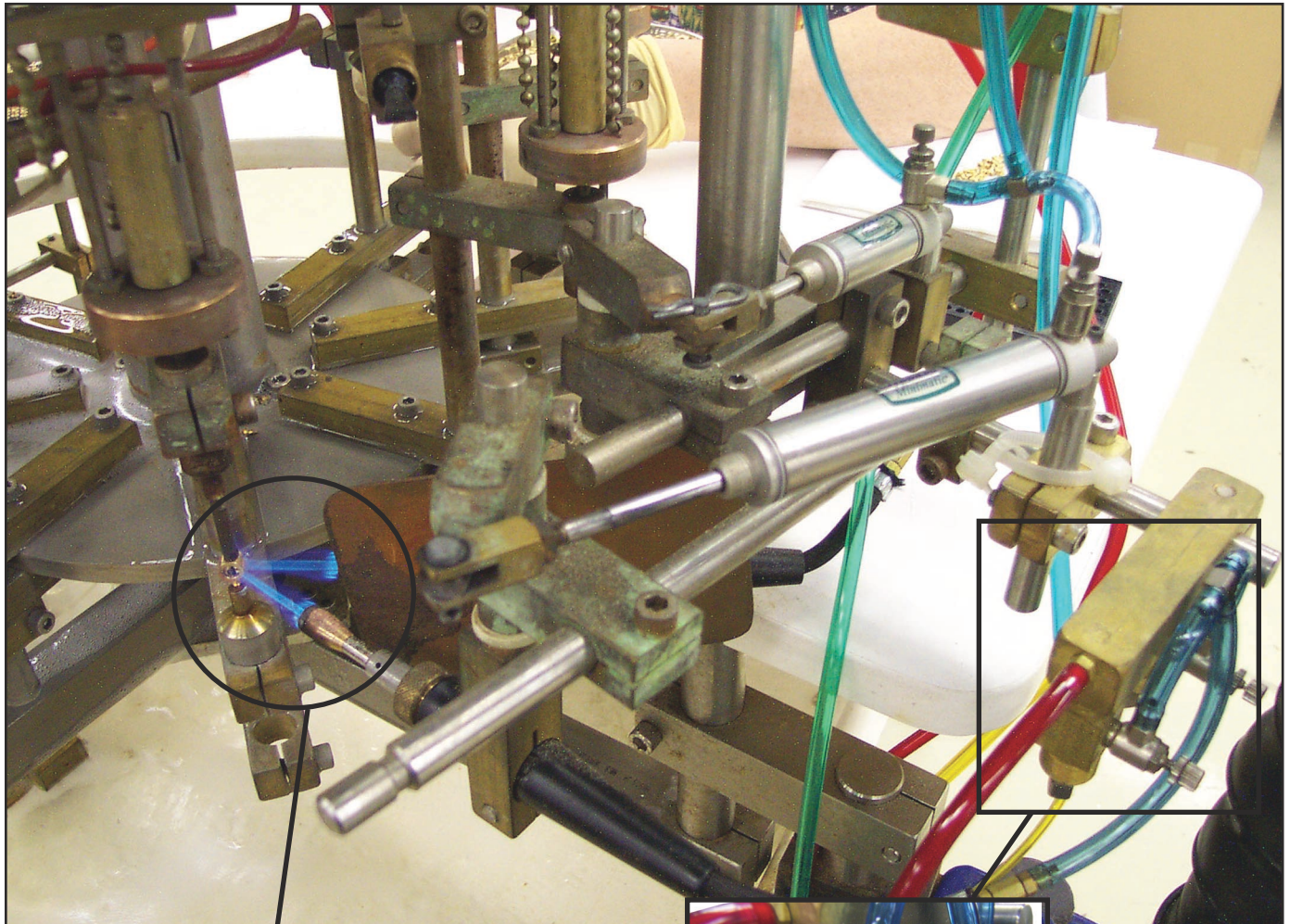

The machine consists of a rotating center carousel with eight stations. The individual components of each slip-on fitting are loaded into clamp fixtures mounted on the carousel.

The carousel indexes to each of the process stations: load, heat, cool, quench, and unload. The control and timing of the machine is accomplished using Clippard modular valves and brass limit valves. Each clamp fixture has its own control circuit for manual and automatic control. Sensors are also incorporated at each clamp fixture to sense the presence of a part.

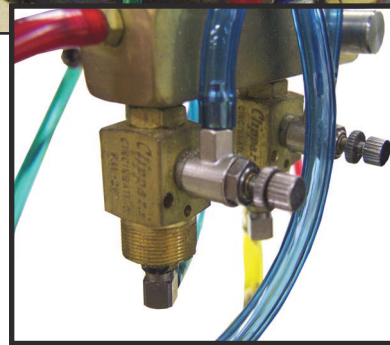

The heat station uses MFC-3AK2's to meter propane, while PAV-2's turn the propane on and off. In addition, the torches are connected to cylinders so they are able to rotate for the heat cycle.



## 11761-2



Buna-N Gasket

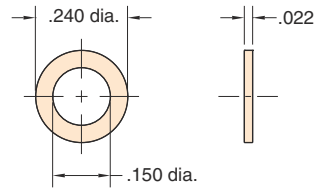

**Material:** Buna-N

**Use:** Buna-N gasket is designed for use with 10-32 threads; included with packaged Clippard fittings; replaces 11761-5

**Temperature Range:** -40 to +250° F

## 11761-3



Fiber Gasket

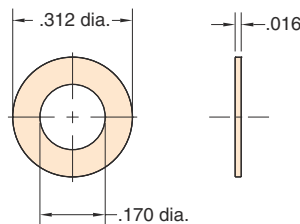

**Material:** Cellulose fiber & SBR latex

**Use:** Designed for use with 10-32 threads in high temperature applications

**Temperature Range:** -40 to +350° F

## 11761-4



Nylon Gasket

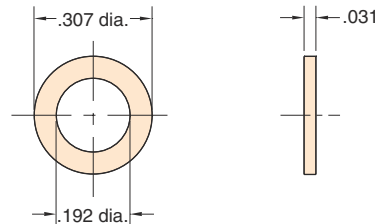

**Material:** Nylon

**Use:** Designed for use with 10-32 threads in applications that require nylon for chemical compatibility

**Temperature Range:** +40 to +200° F

## 11761-7



EPDM

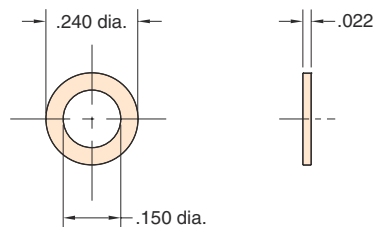

**Material:** EPDM

**Use:** Designed for use with 10-32 threads in applications that require EPDM for low temperature or chemical compatibility; do not use with petroleum-based lubricants

**Temperature Range:** -60 to +300° F

### Gasket Tips

Gaskets are recommended for use with Clippard fittings. They provide snug, dependable seals without extra effort or materials. The most popular gasket for static sealing of 10-32 threads is the 11761-2 Buna-N Gasket. This gasket is included with packaged fittings and comes installed on a variety of Minimatic® slip-on fittings. Overtightening fittings with gaskets may have a tendency to extrude the gasket. While this may be a concern, the actual sealing is being accomplished by a small piece of the gasket at the base of the threads.

### Sealants

There are a number of brands of anaerobic sealants that may be used with Clippard fittings. Anaerobic sealants are applied wet and harden when no longer exposed to air. Their proper use results in a very effective, low cost seal. There are several alternate sealing methods:

1. sealant alone
2. gasket alone
3. home alone (just kidding)
4. gasket and sealant combination

The first two methods will provide adequate sealing for normal air pressures. When extra resistance to vibration is necessary or a permanent orientation of the fitting is required, use of the combination of both gasket and sealant is recommended.

**Material:** Brass

**Thread:** M2.5 - 0.45 (3-56 US equiv.)

**Use:** Threads into Clippard subminiature cylinder; fits 1/16" I.D. hose

**11750-2**

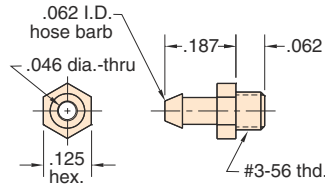

**11749-2**

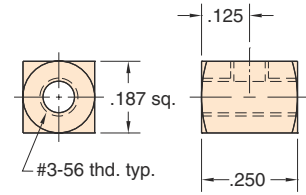

**11749-1**

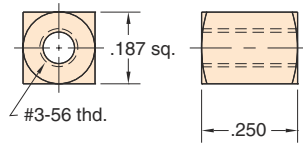

**11749-3**

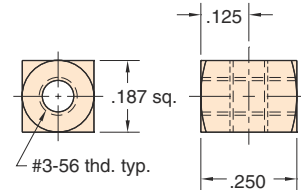

**15070**

10-32 Muffler

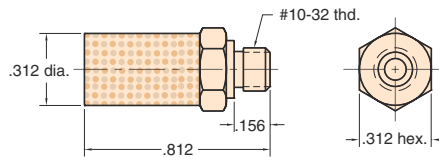

**Material:** Nickel plated brass body sintered stainless steel muffler (60 micron)

**Thread:** 10-32

**Gasket:** Buna-N gasket furnished in package only. Not included when ordered in bulk.

**Use:** To muffle exhausts for quiet system operation

**15080**

1/8 NPT Muffler

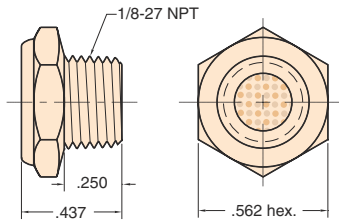

**Material:** Solid brass body; sintered stainless steel insert (100 micron)

**Thread:** 1/8 NPT

**Use:** To muffle exhaust for quiet system operation

**Options:** (-NP)

**11755**

10-32 Screw Plug

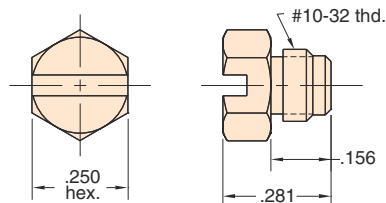

**Material:** Brass

**Thread:** 10-32

**Gasket:** Buna-N gasket furnished in package only. Not included when ordered in bulk.

**Use:** For plugging unused ports in manifolds, air lines and other devices

**Options:** (-NP), (M5)

**0035-2**

10-32 Headless Screw Plug

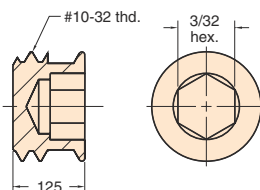

**Material:** Stainless Steel screw plug

**Thread:** 10-32

**Use:** For plugging unused ports in manifold, air lines and other devices that require a flush surface plug; use 3/32 Allen hex wrench to install

**Note:** Thread sealant recommended

## 15036



1/8" NPT to 10-32 Female Bushing

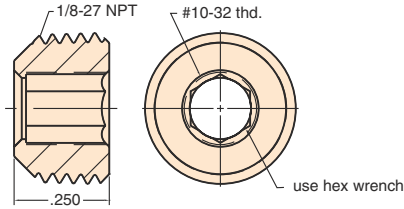

**Material:** Nickel plated brass

**Thread:** 1/8 NPT & 10-32 female

**Use:** Thread sealant  
To convert 1/8" NPT to 10-32 flush thread use thread sealant

## □ C □ F



NPT to 10-32 Female Bushing

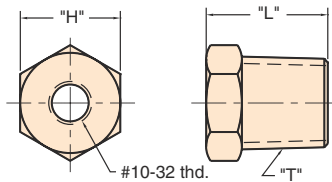

**Material:** Brass

**Thread:** NPT & 10-32 female

**Use:** Will adapt standard pipe to 10-32 fittings and Clippard miniature components

**Options:** (-NP)

	1CJF	2CPF	4CQF	6CWF	8CZF
"T" Thread	1/16 NPT	1/8 NPT	1/4 NPT	3/8 NPT	1/2 NPT
"H" Hex	5/16	7/16	9/16	11/16	13/16
"L" Length	.468	.531	.562	.687	.812



## □ C □ K



NPT to 1/16 NPT Female Bushing

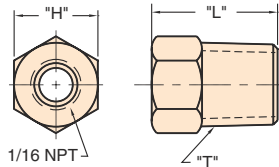

**Material:** Brass

**Thread:** NPT & 1/16 NPT female

**Use:** Will adapt standard pipe to 1/16 NPT fittings and Clippard miniature components

**Options:** (-NP)

	2CPK	4CQK	6CWK	8CZK
"T" Thread	1/8 NPT	1/4 NPT	3/8 NPT	1/2 NPT
"H" Hex	7/16	9/16	11/16	13/16
"L" Length	.531	.562	.687	.812



## □ C □ N



NPT to 1/8 NPT Female Bushing

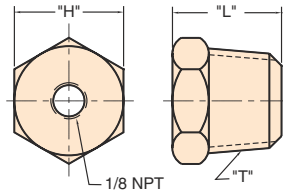

**Material:** Brass

**Thread:** NPT & 1/8 NPT female

**Use:** Will adapt standard pipe to 1/8 NPT fittings and Clippard miniature components

**Options:** (-NP)

	4CQN	6CWN	8CZN
"T" Thread	1/4 NPT	3/8 NPT	1/2 NPT
"H" Hex	9/16	11/16	13/16
"L" Length	.562	.687	.812



## □ C □ Y



NPT to 1/4 NPT Female Bushing

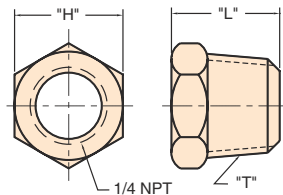

**Material:** Brass

**Thread:** NPT & 1/4 NPT female

**Use:** Will adapt standard pipe to 1/4 NPT fittings and Clippard miniature components

**Seals:** Buna-N o-ring and gasket furnished

**Options:** (-NP)

	6CWY	8CZY
"T" Thread	3/8 NPT	1/2 NPT
"H" Hex	11/16	13/16
"L" Length	.687	.812



## 8CZD



1/2" NPT to 3/8" NPT Female Bushing

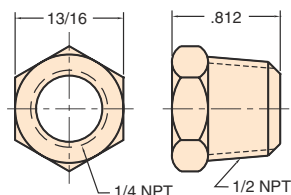

**Material:** Brass

**Thread:** 1/2 NPT & 3/8 NPT female

**Seals:** Buna-N o-ring and gasket furnished

**Use:** Will adapt standard pipe to 3/8 NPT fittings and Clippard miniature components

**Options:** (-NP)



## 15090-1



1/8 NPT to 10-32 "L" Fitting

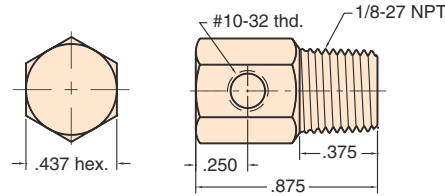

**Material:** Brass

**Thread:** 1/8 NPT to 10-32

**Use:** To provide connections between the two thread sizes with mounting convenience

**Options:** (-NP)



## 15090-2



1/8 NPT to 10-32 "T" Fitting

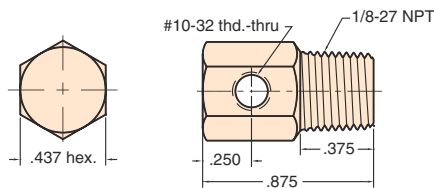

**Material:** Brass

**Thread:** 1/8 NPT to 10-32

**Use:** To provide connections between the two thread sizes with extra mounting convenience

**Options:** (-NP)



## 15090-3



1/8 NPT to 10-32 "X" Cross Fitting

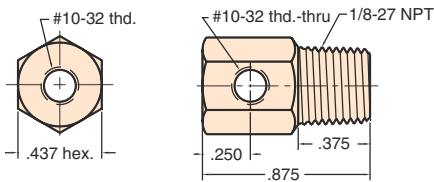

**Material:** Brass

**Thread:** 1/8 NPT to 10-32

**Use:** To provide connections between the two thread sizes; can be used as a miniature manifold

**Options:** (-NP)



## 15027



10-32 Bulkhead Fitting

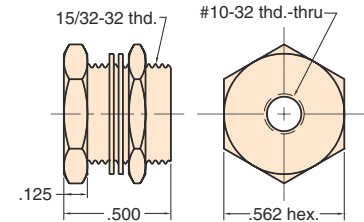

**Material:** Brass

**Thread:** 10-32 tapped both ends

**Locking Nut:** 9/16" furnished with 2 steel lockwashers

**Use:** Provides rigid connection thru panels or bulkheads up to 1/4" thick; use with any Clippard 10-32 threaded fitting or connector

**Options:** (-NP)



## 15029-1



1/8 NPT Bulkhead Fitting

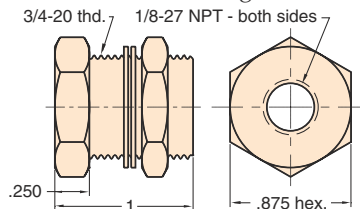

**Material:** Brass

**Thread:** OD - 3/4 - 20, I.D. 1/8 NPT

**Locking Nut:** 7/8" hex furnished with 2 steel lockwashers

**Use:** Provides rigid connection thru panels or bulkheads up to 1/2" thick

**Options:** (-NP)



## 15029-2

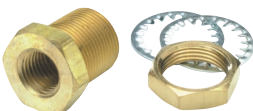

1/4 NPT Bulkhead Fitting

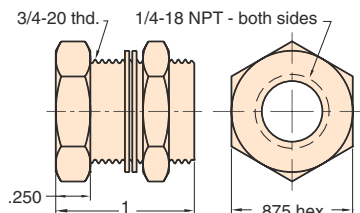

**Material:** Brass

**Thread:** OD - 3/4 - 20, I.D. 1/4 NPT

**Locking Nut:** 7/8" hex furnished with 2 steel lockwashers

**Use:** Provides rigid connection thru panels or bulkheads up to 1/2" thick

**Options:** (-NP)



## MAN-12



### 12-Port Manifold

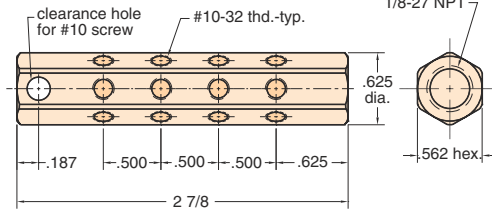

**Material:** Brass

**Thread:** Tapped ports: 1/8" standard pipe tapped inlet

**Mounting:** 13/64" diameter mounting hole

**Use:** May be mounted on jigs, fixtures or machinery to provide up to 12 convenient 10-32 outlets from one standard 1/8" pipe connection; may be used with any Clippard 10-32 fittings, quick connects and many other devices; unused ports can be plugged with screw plug 11755

**Options:** (-NP)



## MRM-6



### 6-Port Rotary Manifold

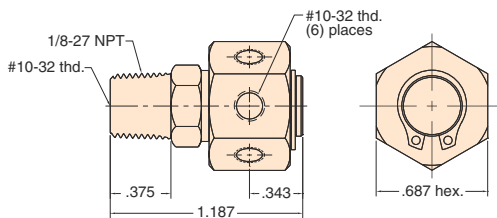

**Material:** Brass and stainless steel

**Thread:** 1/8 NPT for inlet is also tapped 10-32; outlet consists of 6 ports tapped 10-32

**Seals:** Buna-N o-ring furnished

**Working Range:** 250 psi max.

**Air Flow:** 5.9 scfm @ 50 psig

**Use:** May be used either as a rotary joint or as a stationary manifold; ideal for distributing air or liquid from center column onto a rotary index table; unused ports may be plugged with screw plug 11755 and gasket

Low RPM applications

## 15028-□



### Miniature Terminal Blocks

**X to be replaced with:** 4, 6, 8, 10

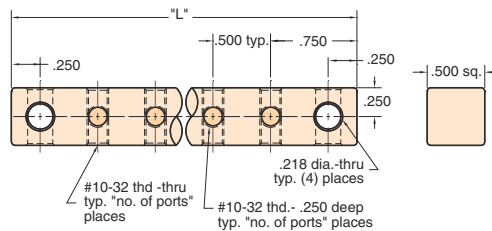

**Material:** Anodized aluminum

**Thread:** 10-32 tapped ports

**Mounting:** With two 7/32: diameter mounting holes

**Use:** To help organize connections in circuit boxes, control panels and machine piping; cross drilled mounting holes permit mounting of "T" in any direction; use screw plug 11755 to plug unused ports

Model #	# of Ports	A	L
15028-4	4	2 1/2"	3"
15028-6	6	3 1/2"	4"
15028-8	8	4 1/2"	5"
15028-10	10	5 1/2"	6"

15028-4 pictured above

## 12292



### Miniature Manifold Stud

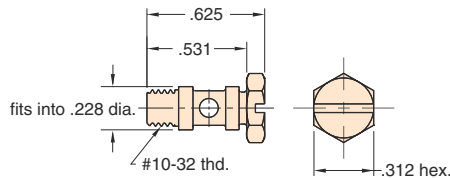

**Material:** Stainless steel

**Thread:** 10-32

**Seals:** Buna-N o-ring and gasket furnished

**Use:** This hollow, cross-drilled stud is useful for connecting specially made manifolds to multiple ports of valves or cylinders, eliminating need for external fittings with hose

## Tips On Using Minimatic® Fittings

### Hose or Tubing Size

The use of different sizes of hose or tubing in your circuits deserves some care and consideration. In general, follow this guide for the size of hose or tubing you use.

For air logic circuits, we recommend:

1/16" ID for pilots

1/8" ID for supplies and outputs



**B□□□-□**

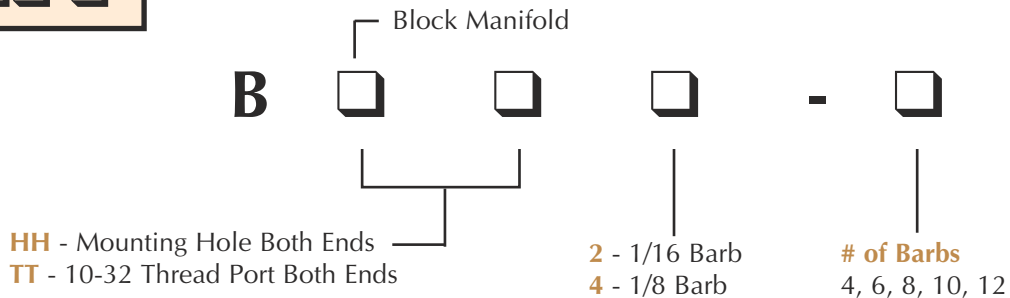

Part #	# of Stations	Fitting Size
BHH2-04	4	1/16" ID Hose Barb
BHH2-06	6	
BHH2-08	8	
BHH2-10	10	
BHH2-12	12	
BHH4-04	4	1/8" ID Hose Barb
BHH4-06	6	
BHH4-08	8	
BHH4-10	10	
BHH4-12	12	

The BHH series has mounting holes for #8 screws at each end. One of the stations must be used as the air supply to the manifold.

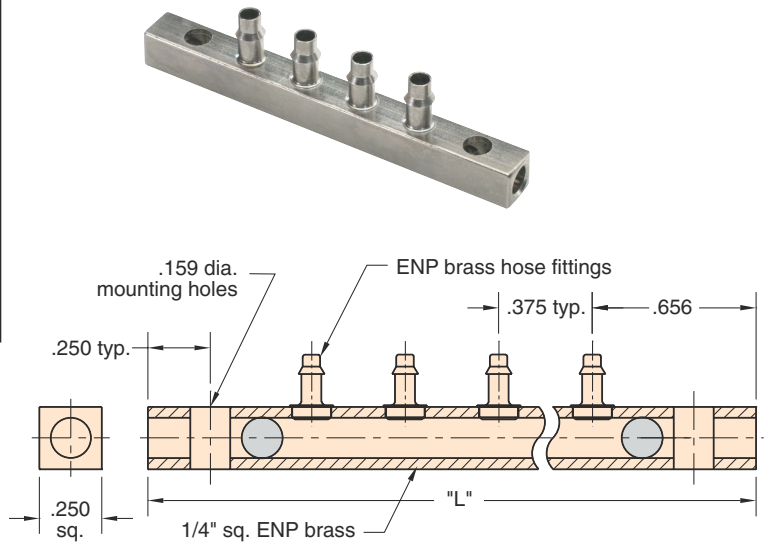

Part #	# of Stations	Fitting Size
BTT2-04	4	1/16" ID Hose Barb
BTT2-06	6	
BTT2-08	8	
BTT2-10	10	
BTT2-12	12	
BTT4-04	4	1/8" ID Hose Barb
BTT4-06	6	
BTT4-08	8	
BTT4-10	10	
BTT4-12	12	

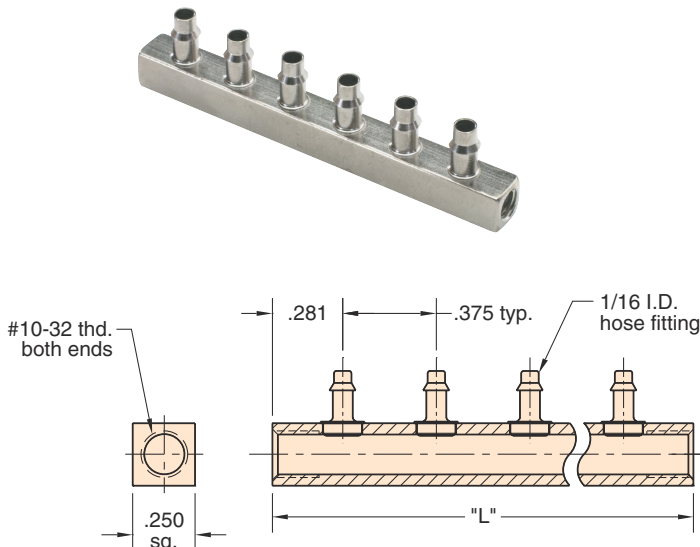

The BTT series has 10-32 holes at each end for inline mounting. One end may be used as the air supply to the manifold and the other end plugged.



# MINIMATIC® J-SERIES QUICK CONNECT

The Minimatic® J-Series quick connect consists of two component parts that are joined to form the complete connector. The valve body contains a 2-way spring-loaded poppet valve that is generally connected to the main air supply. When the poppet is not depressed, the air supply is shut-off by this valve. The Cap contains a valve depressor that when assembled to the valve body, depresses the poppet allowing air to flow from the main supply to circuitry or equipment downstream. Valve body & cap assemblies contain both components.

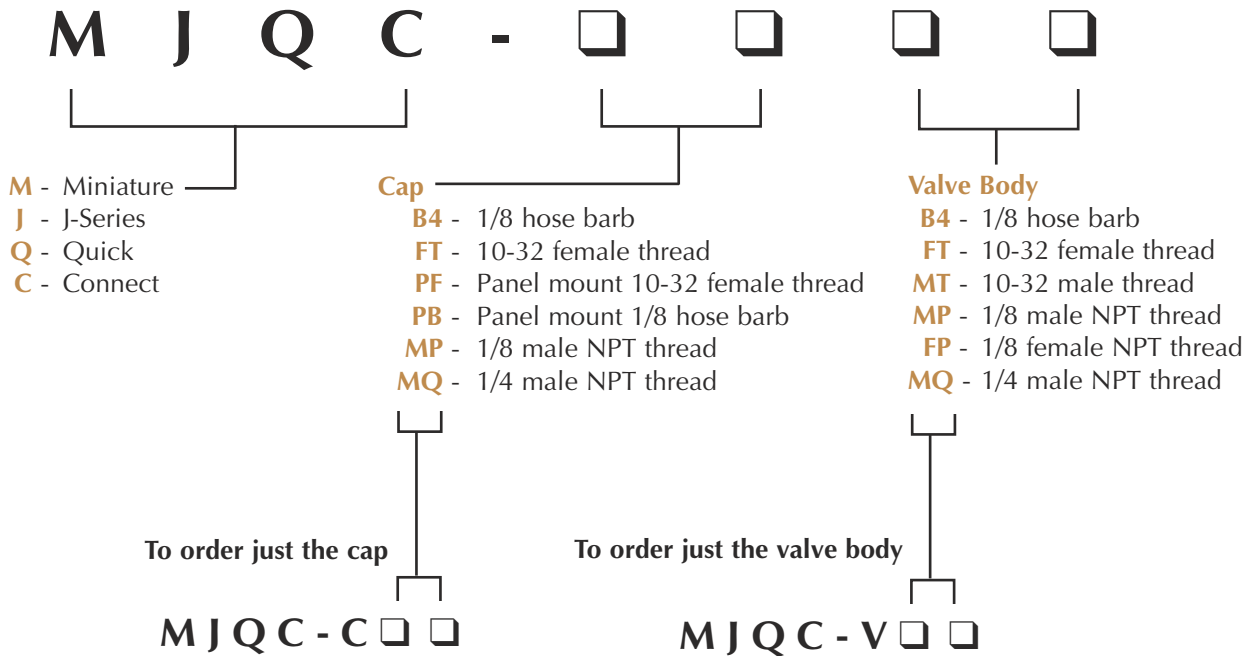

STANDARD CATALOG PARTS		
Assembly	Cap Only	Valve Body Only
MJQC-B4B4	MJQC-CB4	MJQC-VB4
MJQC-B4MP	MJQC-CFT	MJQC-VFT
MJQC-MPB4	MJQC-CMP	MJQC-VFP
MJQC-PBB4	MJQC-CPB	MJQC-VMP
MJQC-PFB4	MJQC-CMQ	MJQC-VMQ

## VALVE BODY & CAP ASSEMBLIES

\*1/8 Barb - fits 1/8 I.D. hose. Ideal for use with Clippard 3814-6 polyurethane hose.

### FEATURES

- High flow of 14 scfm @ 100 psi
- Space saving attractive miniature design
- Wide variety of connectors
- Adds convenience to equipment and circuits
- Brass body, electroless nickel plated
- Non-corrosive - Delrin® poppet
- Fills the gap between clumsy, large quick connects and smaller quick connects with less flow
- Buna-N seals, positive shut off
- Positive threaded connection, stays connected
- Medium: air, oil, and water
- Working Pressure: 0-150 psi max.



Minimatic® J-Series quick connect fittings are very compact yet provide a high flow of 14 scfm@ 100 psi. The electroless nickel plated brass body is available with 10-32 threads (M or F), 1/8 NPT threads (M or F), 1/4 NPT threads (M) or a 1/8 hose single barb configuration that is ideal for use with Clippard 3814-6 polyurethane hose.

### MJQC-B4B4

Combination of MJQC-VB4 & MJQC-CB4

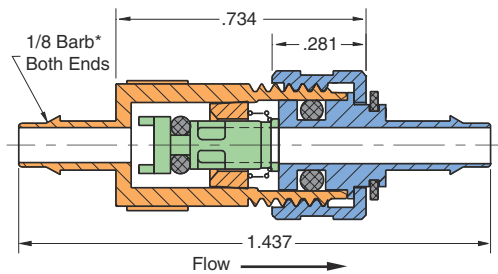

### MJQC-PFB4

Combination of MJQC-VB4 & MJQC-CPF

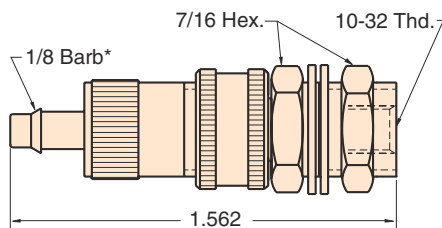

(Supplied with mounting nut and two washers)

### MJQC-MPB4

Combination of MJQC-VB4 & MJQC-CMP

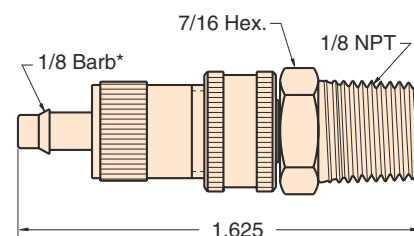

### MJQC-B4MP

Combination of MJQC-VMP & MJQC-CB4

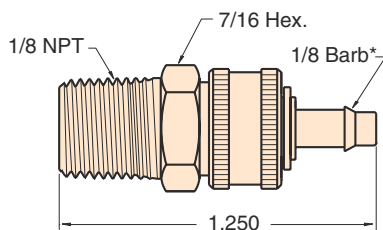

### MJQC-PBB4

Combination of MJQC-VB4 & MJQC-CPB

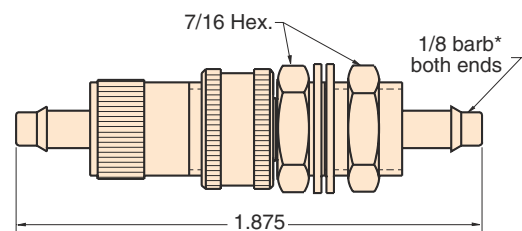

(Supplied with mounting nut and two washers)



# MINIMATIC® J-SERIES QUICK CONNECT

## CAPS

Caps with open flow path

Minimatic® J-Series quick connect fittings are ideal for use in jigs, fixtures, feeding devices, logic control circuitry and automatic or semi-automatic machinery. Assembly is simple, and the tightening of the knurled cap assures a positive, leakproof, high pressure connection that will stay connected.

\*1/8 barb - fits 1/8 I.D. hose. Ideal for use with Clippard 3814-6 polyurethane hose.



## MJQC-CB4

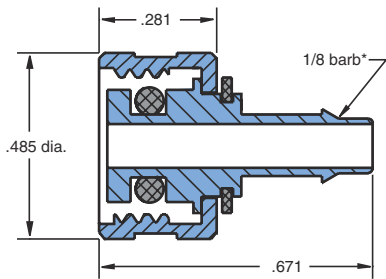

## MJQC-CPB

Supplied with mounting nut and two washers

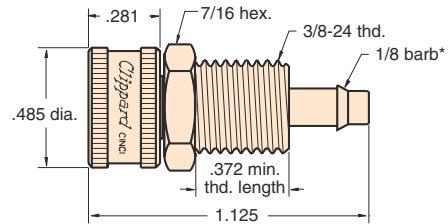

## MJQC-CMQ

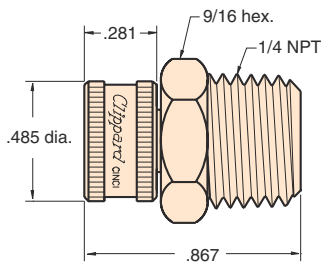

## MJQC-CPF

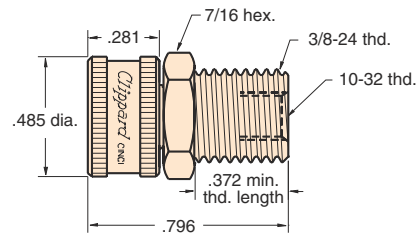

## MJQC-CFT

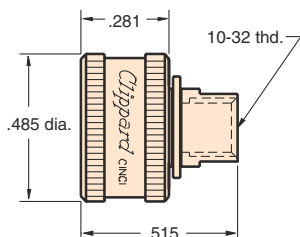

## MJQC-CMP

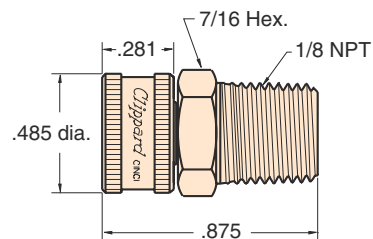



## VALVE BODIES

Valve bodies with shut-off valve

Minimatic® J-Series quick connect fittings are very compact yet provide a high flow of 14 scfm @ 100 psi. The electroless nickel plated brass body is available with 10-32 threads (M or F), 1/8 NPT threads (M or F), 1/4 NPT threads (M) or a 1/8 hose single barb configuration that is ideal for use with Clippard 3814-6 polyurethane hose.



\*1/8 Barb - fits 1/8 I.D. hose. Ideal for use with Clippard 3814-6 polyurethane hose.

### MJQC-VB4

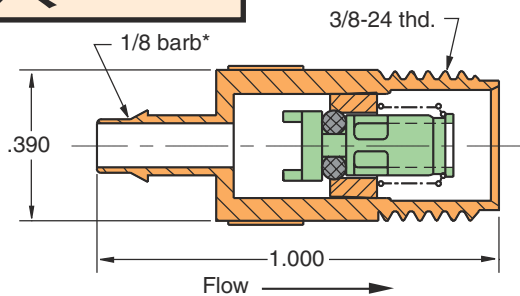

### MJQC-VFP

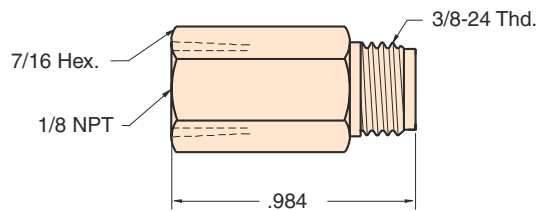

### MJQC-VMT

Supplied with mounting nut and two washers

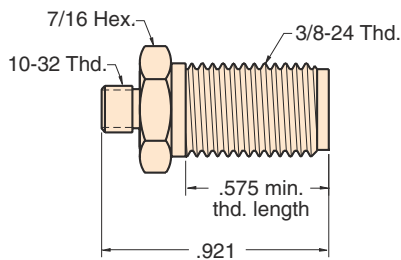

### MJQC-VMQ

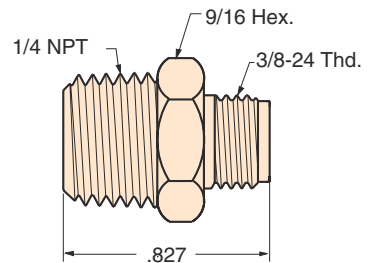

### MJQC-VFT

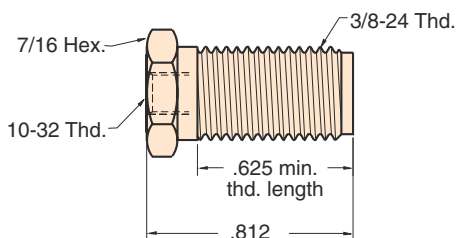

### MJQC-VMP

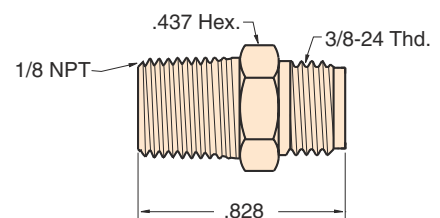



# MINIMATIC® QUICK CONNECT

## MQC-2

Quick Connect Assembly

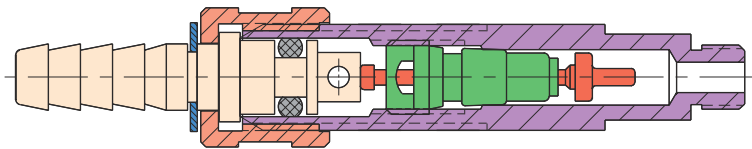
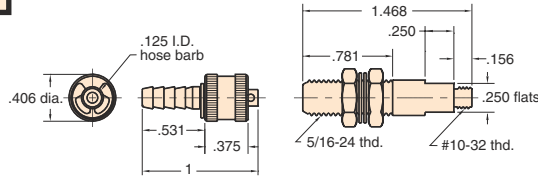

Flow ←

**Type:** One way check quick connect assembly of valve body MQC-V2 and hose connector MQC-F

**Material:** Body- brass, Stem- brass

**Seals:** Buna-N

**Working Pressure:** 0 to 300 psig

**Air Flow:** @ 50 psig - 3.0 scfm  
@ 100 psig - 5.8 scfm

## MQC-3

Quick Connect Assembly

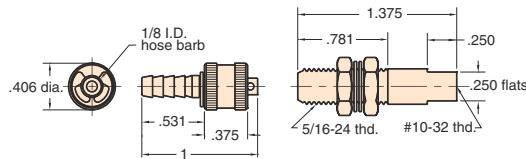

**Type:** One way check quick connect assembly of valve body MQC-V3 and hose connector MQC-F

**Material:** Body- brass, Stem- brass

**Seals:** Buna-N

**Working Pressure:** 0 to 300 psig

**Air Flow:** @ 50 psig - 3.0 scfm  
@ 100 psig - 5.8 scfm

## MQC-V2

Valve Body

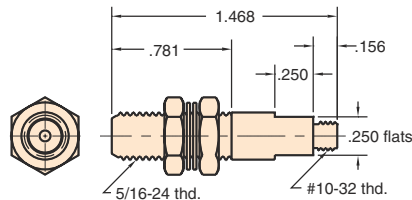

**Material:** Brass

**Thread:** 10-32 male

**Mounting:** In panel or bracket to 1/4" thick with two 7/16" mounting nuts and lockwashers furnished; also screws directly into operative unit or manifold

**Seals:** Buna-N

**Use:** For connection with external shut-off to external hose, use hose connectors: MQC-F, MQC-FT, MQC-F2

**Options:** (-NP)



## MQC-V3

Valve Body

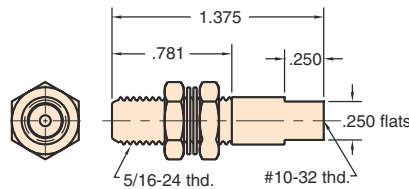

**Material:** Brass

**Thread:** Tapped 10-32

**Mounting:** In panel or bracket to 1/4" thick with two 7/16" mounting nuts and lockwashers furnished; like MQC-V2, but end is tapped 10-32 instead of threaded

**Seals:** Buna-N

**Use:** For connection with external shut-off to external hose, use hose connectors: MQC-F, MQC-FT, MQC-F2

**Options:** (-NP)



## MQC-VP

Valve Body

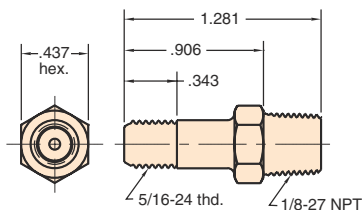

**Material:** Brass

**Thread:** 1/8" NPT base; 5/16-24 body

**Use:** For connection with external shut-off to external hose, use hose connectors: MQC-F, MQC-FT, MQC-F2

**Seals:** Buna-N

**Options:** (-NP), (MR)

## MQC-F



1/8" Hose Connector

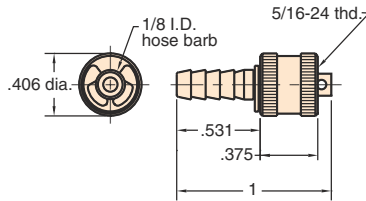

**Material:** Brass

**Thread:** ID of knurled end screws onto male end of valve bodies

**For Use With:** 1/8" ID Vinyl, Buna-N or braided hose

**Installation:** Simply push hose onto barbed end and secure with hose clamp # 5000-1, 5000-2 or 5000-1A.

**Seals:** Buna-N

**Options:** (-NP)



## MQC-F2



1/16" Hose Connector

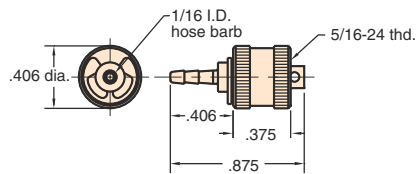

**Material:** Brass

**Thread:** ID of knurled end screws onto male end of valve bodies

**For Use With:** Subminiature 3814-5 1/16" ID vinyl hose

**Installation:** Simply push hose onto barbed end and secure with slip-over hose clamp furnished

**Seals:** Buna-N

**Options:** (-NP)



## MQC-FT



10-32 Tapped Connector

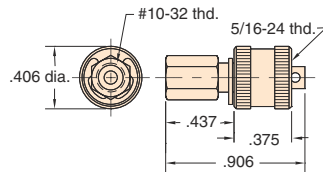

**Material:** Brass

**Thread:** Outlet is tapped 10-32. ID of knurled end screws onto male end of valve bodies: MQC-V2, MQC-V3, MQC-VP

**Mounting:** Outlet mounts with 10-32 short coupling #11999

**Seals:** Buna-N

**Options:** (-NP)





# MINIMATIC® FITTINGS KIT



For the ultimate in convenience, have a selection of helpful fittings available for every need. Keeping a supply of fittings on hand can save money and time, allowing projects, prototypes, circuits, and repairs to be finished quickly and avoiding delays.

These Minimatic® fittings kits contain a variety of the most commonly used fittings and quick connects. The kit saves time ordering and additional parts or replacements can be ordered at any time. Each kit comes in a sturdy plastic case.



## 17555-SF1

### Minimatic® Slip-on Fittings Kit



- UTO-FOF (T) Universal M 10-32 to F 10-32
- UTO-F (L) Universal M 10-32 to F 10-32
- UTF-F (T) Universal M 10-32 to F 10-32
- UTF-FOF (X) Universal M 10-32 to F 10-32
- Inline Connectors
  - C44 1/8" ID Hose to 1/8" ID Hose
  - C42 1/8" ID Hose to 1/16" ID Hose
  - C22 1/16" ID Hose to 1/16" ID Hose
- T22-4 1/8" ID Hose T to 1/16" ID Hoses
- T44-2 1/16" ID Hose T to 1/8" ID Hoses
- X44-404 1/8" ID Hose X
- X22-202 1/16" ID Hose X
- SPO-4 1/8" M NPT to L 1/8" ID Hose
- SPO-2 1/8" M NPT to L 1/16" ID Hose
- SPO-4004 1/8" M NPT to T 1/8" ID Hose
- SPO-2002 1/8" M NPT to T 1/16" ID Hose
- T22-2 1/16" ID Hose T
- T44-4 1/8" ID Hose T
- XT4-404 1/8" ID Hose X with M 10-32
- XT2-202 1/16" ID Hose X with M 10-32
- CT2 1/16" ID Hose to M 10-32
- CT4 1/8" ID Hose to M 10-32
- Inline Swivel Connectors
  - S44 1/8" ID Hose to 1/8" ID Hose
  - ST4 1/8" ID Hose to M 10-32
  - S4F 1/8" ID Hose to F 10-32

#### Contains:

- CTO-2 Connector L 1/16" ID Hose to M 10-32
- UTO-2 Universal L 1/16" ID Hose to M 10-32
- STO-2 Swivel L 1/16" ID Hose to M 10-32
- CTO-4 Connector L 1/8" ID Hose to M 10-32
- UTO-4 Universal L 1/8" ID Hose to M 10-32
- STO-4 Swivel L 1/8" ID Hose to M 10-32
- TTO-202 Connector 1/16" ID Hose T with M 10-32
- UTO-2002 Universal 1/16" ID Hose T with M 10-32
- STO-2002 Swivel 1/16" ID Hose T with M 10-32
- TTO-404 Connector 1/8" ID Hose T with M 10-32
- UTO-4004 Universal 1/8" ID Hose T with M 10-32
- STO-4004 Swivel 1/8" ID Hose T with M 10-32
- Clippard 1/4" & 5/16" Wrench 11770
- Gasket 11761-2
- Hose Samples